

Concealite Life Safety Products©
202 Elk Street, Elkton, SD 57026
(605) 531-5588
info@concealite.com
All Rights Reserved
Printed in USA Patents Pending



Concealed Emergency Lighting, Exits & Fire Alarm Products
www.concealite.com

F5000 Series (Battery System Included)

Control Number: 3198345
Emergency Lighting and Power Equipment [UL
924:2016 Ed.10+R:14Dec2022]



Included Features & Equipment

The F5000 Emergency Light is Concealite's innovative fully-concealed solution that blends seamlessly into any wall or ceiling, preserving aesthetic elegance while remaining ready to provide reliable illumination the moment it is needed. Designed to meet all safety requirements, the F5000's versatile, industry-leading design caters to high-end architectural installations while remaining cost-effective for every project and environment, offering unmatched efficiency and style. It is tested to UL 924 Standards and has an ETL listing.

Concealed Emergency Fixture

Completely concealed fixture assembly with 180° automatic rotating door.

High-Efficiency LED Lamps

Two high-efficiency 8 watt LED lamps, adjustable up to 180 degrees for versatile illumination. Delivers industry-leading efficiency for optimal performance in all emergency applications. Ensures easy and efficient compliance with NFPA 101 Life Safety.

Integrated Flange Mount

Designed for secure and straightforward installation into any wall or ceiling, ensuring a stable and reliable setup in just 10 minutes with all necessary tools included.

Universal Power Input

Normal power is supported with a universal 120/277 Volt 60 Hz input, accommodating a wide range of electrical systems for seamless integration.

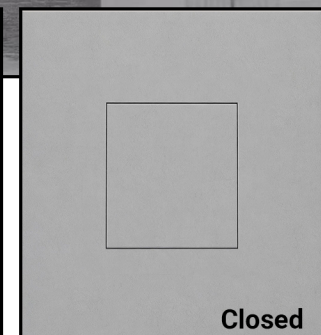
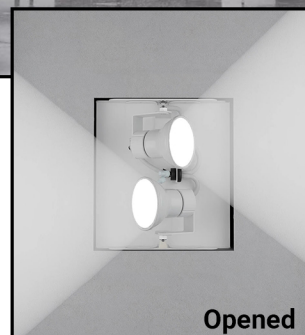
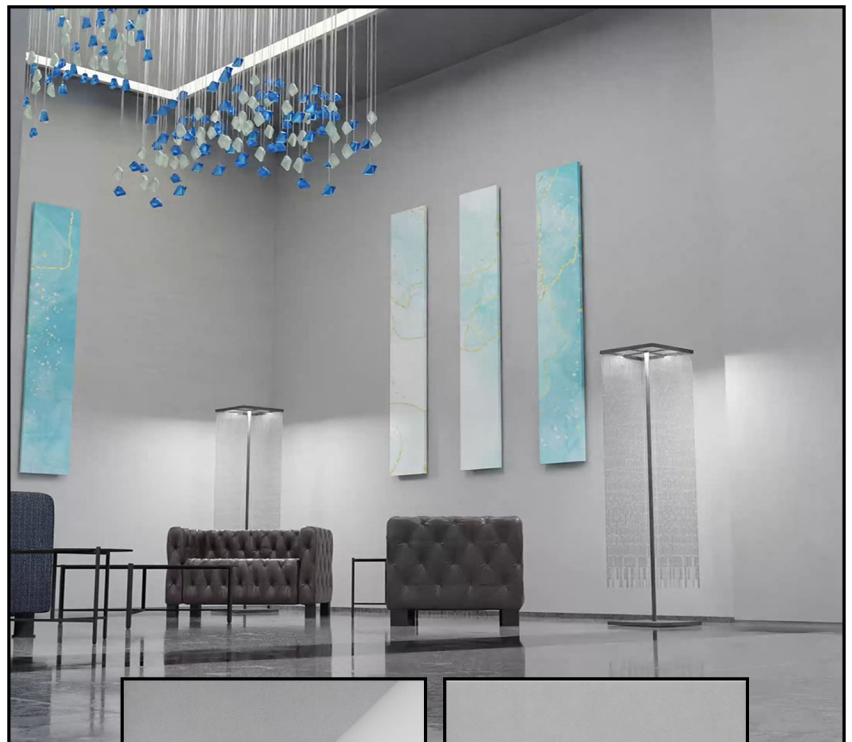

F5000 Series

(Battery System Included)

Features & Equipment

Self-Contained Emergency Battery Back Up

Available in 90 Minute, 2 and 4 hours run times. Complies with UL 924's ninety-minute minimum and all emergency standards. Additional runtime selections ensure reliable performance for all scenarios, including hospital-grade requirements.

Self-Diagnostic

Our self-diagnostic system continuously monitors all system components to ensure reliability and increase facility efficiency. It automatically detects and indicates real-time system conditions. Compliant with UL 924 standards, it meets stringent requirements for emergency lighting functionality and testing.

Damp Label Rating

The Damp Label rating ensures consistent performance in damp conditions. IP44 rated.

R2 Back Box Dimensions

R2 back box included with 2 hour and 4-hour battery backup options.

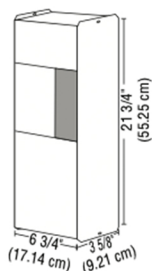

Recessed Backbox Enclosure

Includes recessed backbox, adjustable fixture mounting system, and recesses all fixture components for installation within a standard 3 1/2-inch wall cavity..

Straightforward Installation

All necessary tools and hardware are included for quick, hassle-free deployment. The recessed enclosure ensures all components and wiring connections remain accessible, with the fixture head secured by four easily accessible internal concealed fasteners.

White Powder Coat Factory Finish

A versatile and widely used color that seamlessly complements most interior designs and color schemes..

Warranty

Three-year limited warranty.

Unit Dimensions

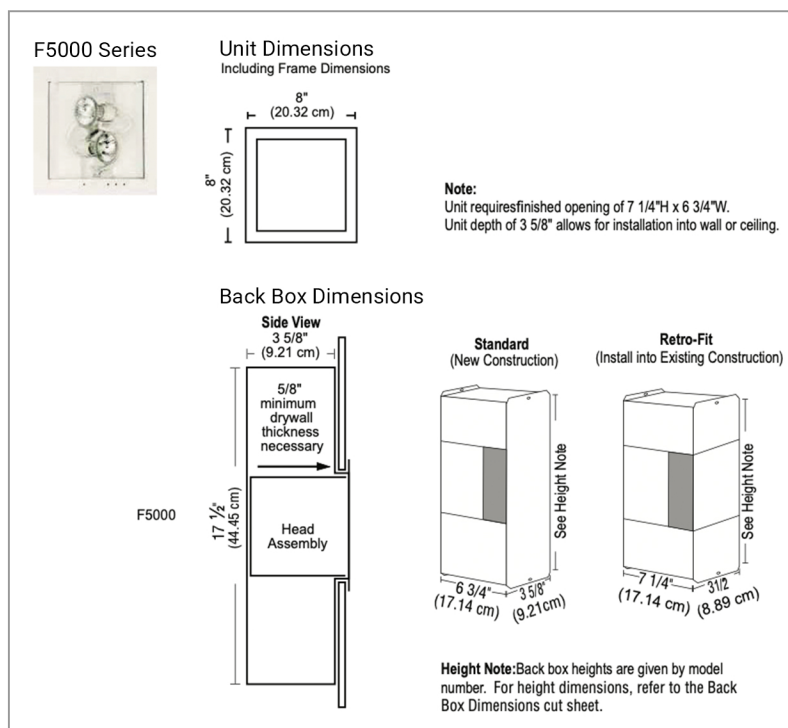

F5000 Series

(Battery System Included)

Optional Added Equipment

Flush Mounting System (FMS)

Allows for seamless, flush integration into walls or ceilings and further improving aesthetics for mud-in applications. (Gypsum board, Concrete Masonry and Plaster)

T-Bar Suspended Ceiling Tile Mounting Assembly (TBAR)

Selectable T-Bar hardware for suspended ceiling applications secures the backbox and fixture to the T-grid ceiling assembly.

Custom Powder Coat Finish (CF)

Available in any RAL color, providing a perfect match for your design aesthetic. RAL is specified at ordering.

Retrofit Backbox (RB)

Designed for existing structures, the retrofit backbox enables seamless installation of the F5000 in pre-existing walls or ceilings, ensuring compatibility with all construction types with easy setup.

Surface Mount Box (SM)

Designed for installations where recessing components isn't feasible, this backbox enables surface mounting on walls and ceilings. Features a clean aesthetically pleasing appearance with a white powder coat factory finish to complement most interior designs.

Sealed Plenum-Rated Back Box (CCEA)

Chicago Plenum-Rated Backbox: Complies with City of Chicago Environmental Air (CCEA) requirements (Section 18-27-300.22) and City of Chicago Fire Code, (Sections 14E-3-314 and 14E-7-700.10) for Chicago junction box requirements in Non-Plenum installations. 2 "LARGE"

Ordering Information

Typical Specifications

#F5-8-90-SD-FMS

F5000 Series

F5 F5000 Series Concealed
Emergency Lighting

LED Lamps

8 Two High-Efficiency LED 8w MR16 Lamps

Hours of Operation

90 90 minutes of Battery Backup
Emergency Lighting Operation
2 Two (2) Hours of Operation
4 Four (4) Hours of Operation

Self-Diagnostic

SD Self-Diagnostic System

Options

FMS Flush Mounting System,
Trimless Frame

CF Custom Finish (Specify RAL
Color # at Ordering)

TBAR T-Bar Suspended Ceiling Tile
Mounting Assembly

SM Surface Mount Box

RB Retrofit Recessed Mounting
Back Box For Remodeling
Existing Building Projects

CCEA City of Chicago Environmental
Installation Requirements

F5000 Series

(Battery System Included)

Part Numbers

F5-8-90-SD	F5000 Series (F5), 8 Watt MR16 LED (8), 90 Minute Run Time (90), Self Diagnostic System (SD)
F5-8-90-SD-FMS	F5000 Series (F5), 8 Watt MR16 LED (8), 90 Minute Run Time (90), Self Diagnostic System (SD), Flush Mounting System (FMS)
F5-8-90-SD-CF	F5000 Series (F5), 8 Watt MR16 LED (8), 90 Minute Run Time (90), Self Diagnostic System (SD), Custom Finish, Per-Fixture Note U.S. RAL# Required (CF)
F5-8-90-SD-FMS-CF	F5000 Series (F5), 8 Watt MR16 LED (8), 90 Minute Run Time (90), Self Diagnostic System (SD), Flush Mounting System (FMS), Custom Finish, Per-Fixture Note U.S. RAL# Required (CF)
F5-8-90-SD-TBAR	F5000 Series (F5), 8 Watt MR16 LED (8), 90 Minute Run Time (90), Self Diagnostic System (SD), T-Grid, T-Bar Mounting Kit (TBAR)
F5-8-90-SD-TBAR	F5000 Series (F5), 8 Watt MR16 LED (8), 90 Minute Run Time (90), Self Diagnostic System (SD), Flush Mounting System (FMS), T-Grid, T-Bar Mounting Kit (TBAR)
F5-8-90-SD-CF-TBAR	F5000 Series (F5), 8 Watt MR16 LED (8), 90 Minute Run Time (90), Self Diagnostic System (SD), Custom Finish, Per-Fixture Note U.S. RAL# Required (CF), T-Grid, T-Bar Mounting Kit (TBAR)
F5-8-90-SD-FMS-CF-TBAR	F5000 Series (F5), 8 Watt MR16 LED (8), 90 Minute Run Time (90), Self Diagnostic System (SD), Flush Mounting System (FMS), Custom Finish, Per-Fixture Note U.S. RAL# Required (CF), T-Grid, T-Bar Mounting Kit (TBAR)
F5-8-90-SD-RB	F5000 Series (F5), 8 Watt MR16 LED (8), 90 Minute Run Time (90), Self Diagnostic System (SD), Retro Fit Back Box for Existing Walls and Ceiling (RB)
F5-8-90-SD-FMS-RB	F5000 Series (F5), 8 Watt MR16 LED (8), 90 Minute Run Time (90), Self Diagnostic System (SD), Flush Mounting System (FMS), Retro Fit Back Box for Existing Walls and Ceiling (RB)
F5-8-90-SD-CF-RB	F5000 Series (F5), 8 Watt MR16 LED (8), 90 Minute Run Time (90), Self Diagnostic System (SD), Custom Finish, Per-Fixture Note U.S. RAL# Required (CF), Retro Fit Back Box for Existing Walls and Ceiling (RB)
F5-8-90-SD-FMS-CF-RB	F5000 Series (F5), 8 Watt MR16 LED (8), 90 Minute Run Time (90), Self Diagnostic System (SD), Flush Mounting System (FMS), Custom Finish, Per-Fixture Note U.S. RAL# Required (CF), Retro Fit Back Box for Existing Walls and Ceiling (RB)
F5-8-90-SD-SM	F5000 Series (F5), 8 Watt MR16 LED (8), 90 Minute Run Time (90), Self Diagnostic System (SD), Surface Mount Box with White Finish (SM)
F5-8-90-SD-CF-SM	F5000 Series (F5), 8 Watt MR16 LED (8), 90 Minute Run Time (90), Self Diagnostic System (SD), Custom Finish, Per-Fixture Note U.S. RAL# Required (CF), Surface Mount Box with White Finish (SM)
F5-8-90-SD-TBAR-SM	F5000 Series (F5), 8 Watt MR16 LED (8), 90 Minute Run Time (90), Self Diagnostic System (SD), T-Grid, T-Bar Mounting Kit (TBAR), Surface Mount Box with White Finish (SM)

F5000 Series

(Battery System Included)

Part Numbers

F5-8-90-SD-CF-TBAR-SM	F5000 Series (F5), 8 Watt MR16 LED (8), 90 Minute Run Time (90), Self Diagnostic System (SD), Custom Finish, Per-Fixture Note U.S. RAL# Required (CF), T-Grid, T-Bar Mounting Kit (TBAR), Surface Mount Box with White Finish (SM)
F5-8-90-SD-CCEA	F5000 Series (F5), 8 Watt MR16 LED (8), 90 Minute Run Time (90), Self Diagnostic System (SD), City of Chicago Code Required Plenum Rated Sealed Recessed Back Box (CCEA)
F5-8-90-SD-FMS-CCEA	F5000 Series (F5), 8 Watt MR16 LED (8), 90 Minute Run Time (90), Self Diagnostic System (SD), Flush Mounting System (FMS), City of Chicago Code Required Plenum Rated Sealed Recessed Back Box (CCEA)
F5-8-90-SD-CF-CCEA	F5000 Series (F5), 8 Watt MR16 LED (8), 90 Minute Run Time (90), Self Diagnostic System (SD), Custom Finish, Per-Fixture Note U.S. RAL# Required (CF), City of Chicago Code Required Plenum Rated Sealed Recessed Back Box (CCEA)
F5-8-90-SD-FMS-CF-CCEA	F5000 Series (F5), 8 Watt MR16 LED (8), 90 Minute Run Time (90), Self Diagnostic System (SD), Flush Mounting System (FMS), Custom Finish, Per-Fixture Note U.S. RAL# Required (CF), City of Chicago Code Required Plenum Rated Sealed Recessed Back Box (CCEA)
F5-8-90-SD-TBAR-CCEA	F5000 Series (F5), 8 Watt MR16 LED (8), 90 Minute Run Time (90), Self Diagnostic System (SD), T-Grid, T-Bar Mounting Kit (TBAR), City of Chicago Code Required Plenum Rated Sealed Recessed Back Box (CCEA)
F5-8-90-SD-FMS-TBAR-CCEA	F5000 Series (F5), 8 Watt MR16 LED (8), 90 Minute Run Time (90), Self Diagnostic System (SD), Flush Mounting System (FMS), T-Grid, T-Bar Mounting Kit (TBAR), City of Chicago Code Required Plenum Rated Sealed Recessed Back Box (CCEA)
F5-8-90-SD-CF-TBAR-CCEA	F5000 Series (F5), 8 Watt MR16 LED (8), 90 Minute Run Time (90), Self Diagnostic System (SD), Custom Finish, Per-Fixture Note U.S. RAL# Required (CF), T-Grid, T-Bar Mounting Kit (TBAR), City of Chicago Code Required Plenum Rated Sealed Recessed Back Box (CCEA)
F5-8-90-SD-FMS-CF-TBAR-CCEA	F5000 Series (F5), 8 Watt MR16 LED (8), 90 Minute Run Time (90), Self Diagnostic System (SD), Flush Mounting System (FMS), Custom Finish, Per-Fixture Note U.S. RAL# Required (CF), T-Grid, T-Bar Mounting Kit (TBAR), City of Chicago Code Required Plenum Rated Sealed Recessed Back Box (CCEA)
F5-8-2-SD	F5000 Series (F5), 8 Watt MR16 LED (8), 2 Hour Run Time (2), Self Diagnostic System (SD)
F5-8-2-SD-FMS	F5000 Series (F5), 8 Watt MR16 LED (8), 2 Hour Run Time (2), Self Diagnostic System (SD), Flush Mounting System (FMS)
F5-8-2-SD-CF	F5000 Series (F5), 8 Watt MR16 LED (8), 2 Hour Run Time (2), Self Diagnostic System (SD), Custom Finish, Per-Fixture Note U.S. RAL# Required (CF)
F5-8-2-SD-FMS-CF	F5000 Series (F5), 8 Watt MR16 LED (8), 2 Hour Run Time (2), Self Diagnostic System (SD), Flush Mounting System (FMS), Custom Finish, Per-Fixture Note U.S. RAL# Required (CF)

F5000 Series

(Battery System Included)

Part Numbers

F5-8-2-SD-TBAR	F5000 Series (F5), 8 Watt MR16 LED (8), 2 Hour Run Time (2), Self Diagnostic System (SD), T-Grid, T-Bar Mounting Kit (TBAR)
F5-8-2-SD-FMS-TBAR	F5000 Series (F5), 8 Watt MR16 LED (8), 2 Hour Run Time (2), Self Diagnostic System (SD), Flush Mounting System (FMS), T-Grid, T-Bar Mounting Kit (TBAR)
F5-8-2-SD-CF-TBAR	F5000 Series (F5), 8 Watt MR16 LED (8), 2 Hour Run Time (2), Self Diagnostic System (SD), Custom Finish, Per-Fixture Note U.S. RAL# Required (CF), T-Grid, T-Bar Mounting Kit (TBAR)
F5-8-2-SD-FMS-CF-TBAR	F5000 Series (F5), 8 Watt MR16 LED (8), 2 Hour Run Time (2), Self Diagnostic System (SD), Flush Mounting System (FMS), Custom Finish, Per-Fixture Note U.S. RAL# Required (CF), T-Grid, T-Bar Mounting Kit (TBAR)
F5-8-2-SD-RB	F5000 Series (F5), 8 Watt MR16 LED (8), 2 Hour Run Time (2), Self Diagnostic System (SD), Retro Fit Back Box for Existing Walls and Ceiling (RB)
F5-8-2-SD-FMS-RB	F5000 Series (F5), 8 Watt MR16 LED (8), 2 Hour Run Time (2), Self Diagnostic System (SD), Flush Mounting System (FMS), Retro Fit Back Box for Existing Walls and Ceiling (RB)
F5-8-2-SD-CF-RB	F5000 Series (F5), 8 Watt MR16 LED (8), 2 Hour Run Time (2), Self Diagnostic System (SD), Custom Finish, Per-Fixture Note U.S. RAL# Required (CF), Retro Fit Back Box for Existing Walls and Ceiling (RB)
F5-8-2-SD-FMS-CF-RB	F5000 Series (F5), 8 Watt MR16 LED (8), 2 Hour Run Time (2), Self Diagnostic System (SD), Flush Mounting System (FMS), Custom Finish, Per-Fixture Note U.S. RAL# Required (CF), Retro Fit Back Box for Existing Walls and Ceiling (RB)
F5-8-2-SD-SM	F5000 Series (F5), 8 Watt MR16 LED (8), 2 Hour Run Time (2), Self Diagnostic System (SD), Surface Mount Box with White Finish (SM)
F5-8-2-SD-CF-SM	F5000 Series (F5), 8 Watt MR16 LED (8), 2 Hour Run Time (2), Self Diagnostic System (SD), Custom Finish, Per-Fixture Note U.S. RAL# Required (CF), Surface Mount Box with White Finish (SM)
F5-8-2-SD-TBAR-SM	F5000 Series (F5), 8 Watt MR16 LED (8), 2 Hour Run Time (2), Self Diagnostic System (SD), T-Grid, T-Bar Mounting Kit (TBAR), Surface Mount Box with White Finish (SM)
F5-8-2-SD-CF-TBAR-SM	F5000 Series (F5), 8 Watt MR16 LED (8), 2 Hour Run Time (2), Self Diagnostic System (SD), Custom Finish, Per-Fixture Note U.S. RAL# Required (CF), T-Grid, T-Bar Mounting Kit (TBAR), Surface Mount Box with White Finish (SM)
F5-8-2-SD-CCEA	F5000 Series (F5), 8 Watt MR16 LED (8), 2 Hour Run Time (2), Self Diagnostic System (SD), City of Chicago Code Required Plenum Rated Sealed Recessed Back Box (CCEA)
F5-8-2-SD-FMS-CCEA	F5000 Series (F5), 8 Watt MR16 LED (8), 2 Hour Run Time (2), Self Diagnostic System (SD), Flush Mounting System (FMS), City of Chicago Code Required Plenum Rated Sealed Recessed Back Box (CCEA)

F5000 Series

(Battery System Included)

Part Numbers

F5-8-2-SD-CF-CCEA	F5000 Series (F5), 8 Watt MR16 LED (8), 2 Hour Run Time (2), Self Diagnostic System (SD), Custom Finish, Per-Fixture Note U.S. RAL# Required (CF), City of Chicago Code Required Plenum Rated Sealed Recessed Back Box (CCEA)
F5-8-2-SD-FMS-CF-CCEA	F5000 Series (F5), 8 Watt MR16 LED (8), 2 Hour Run Time (2), Self Diagnostic System (SD), Flush Mounting System (FMS), Custom Finish, Per-Fixture Note U.S. RAL# Required (CF), City of Chicago Code Required Plenum Rated Sealed Recessed Back Box (CCEA)
F5-8-2-SD-TBAR-CCEA	F5000 Series (F5), 8 Watt MR16 LED (8), 2 Hour Run Time (2), Self Diagnostic System (SD), T-Grid, T-Bar Mounting Kit (TBAR), City of Chicago Code Required Plenum Rated Sealed Recessed Back Box (CCEA)
F5-8-2-SD-FMS-TBAR-CCEA	F5000 Series (F5), 8 Watt MR16 LED (8), 2 Hour Run Time (2), Self Diagnostic System (SD), Flush Mounting System (FMS), T-Grid, T-Bar Mounting Kit (TBAR), City of Chicago Code Required Plenum Rated Sealed Recessed Back Box (CCEA)
F5-8-2-SD-CF-TBAR-CCEA	F5000 Series (F5), 8 Watt MR16 LED (8), 2 Hour Run Time (2), Self Diagnostic System (SD), Custom Finish, Per-Fixture Note U.S. RAL# Required (CF), T-Grid, T-Bar Mounting Kit (TBAR), City of Chicago Code Required Plenum Rated Sealed Recessed Back Box (CCEA)
F5-8-2-SD-FMS-CF-TBAR-CCEA	F5000 Series (F5), 8 Watt MR16 LED (8), 2 Hour Run Time (2), Self Diagnostic System (SD), Flush Mounting System (FMS), Custom Finish, Per-Fixture Note U.S. RAL# Required (CF), T-Grid, T-Bar Mounting Kit (TBAR), City of Chicago Code Required Plenum Rated Sealed Recessed Back Box (CCEA)
F5-8-4-SD	F5000 Series (F5), 8 Watt MR16 LED (8), 4 Hour Run Time (4), Self Diagnostic System (SD)
F5-8-4-SD-FMS	F5000 Series (F5), 8 Watt MR16 LED (8), 4 Hour Run Time (4), Self Diagnostic System (SD), Flush Mounting System (FMS)
F5-8-4-SD-CF	F5000 Series (F5), 8 Watt MR16 LED (8), 4 Hour Run Time (4), Self Diagnostic System (SD), Custom Finish, Per-Fixture Note U.S. RAL# Required (CF)
F5-8-4-SD-FMS-CF	F5000 Series (F5), 8 Watt MR16 LED (8), 4 Hour Run Time (4), Self Diagnostic System (SD), Flush Mounting System (FMS), Custom Finish, Per-Fixture Note U.S. RAL# Required (CF)
F5-8-4-SD-TBAR	F5000 Series (F5), 8 Watt MR16 LED (8), 4 Hour Run Time (4), Self Diagnostic System (SD), T-Grid, T-Bar Mounting Kit (TBAR)
F5-8-4-SD-FMS-TBAR	F5000 Series (F5), 8 Watt MR16 LED (8), 4 Hour Run Time (4), Self Diagnostic System (SD), Flush Mounting System (FMS), T-Grid, T-Bar Mounting Kit (TBAR)
F5-8-4-SD-CF-TBAR	F5000 Series (F5), 8 Watt MR16 LED (8), 4 Hour Run Time (4), Self Diagnostic System (SD), Custom Finish, Per-Fixture Note U.S. RAL# Required (CF), T-Grid, T-Bar Mounting Kit (TBAR)

F5000 Series

(Battery System Included)

Part Numbers

F5-8-4-SD-FMS-CF-TBAR	F5000 Series (F5), 8 Watt MR16 LED (8), 4 Hour Run Time (4), Self Diagnostic System (SD), Flush Mounting System (FMS), Custom Finish, Per-Fixture Note U.S. RAL# Required (CF), T-Grid, T-Bar Mounting Kit (TBAR)
F5-8-4-SD-RB	F5000 Series (F5), 8 Watt MR16 LED (8), 4 Hour Run Time (4), Self Diagnostic System (SD), Retro Fit Back Box for Existing Walls and Ceiling (RB)
F5-8-4-SD-FMS-RB	F5000 Series (F5), 8 Watt MR16 LED (8), 4 Hour Run Time (4), Self Diagnostic System (SD), Flush Mounting System (FMS), Retro Fit Back Box for Existing Walls and Ceiling (RB)
F5-8-4-SD-CF-RB	F5000 Series (F5), 8 Watt MR16 LED (8), 4 Hour Run Time (4), Self Diagnostic System (SD), Custom Finish, Per-Fixture Note U.S. RAL# Required (CF), Retro Fit Back Box for Existing Walls and Ceiling (RB)
F5-8-4-SD-FMS-CF-RB	F5000 Series (F5), 8 Watt MR16 LED (8), 4 Hour Run Time (4), Self Diagnostic System (SD), Flush Mounting System (FMS), Custom Finish, Per-Fixture Note U.S. RAL# Required (CF), Retro Fit Back Box for Existing Walls and Ceiling (RB)
F5-8-4-SD-SM	F5000 Series (F5), 8 Watt MR16 LED (8), 4 Hour Run Time (4), Self Diagnostic System (SD), Surface Mount Box with White Finish (SM)
F5-8-4-SD-CF-SM	F5000 Series (F5), 8 Watt MR16 LED (8), 4 Hour Run Time (4), Self Diagnostic System (SD), Custom Finish, Per-Fixture Note U.S. RAL# Required (CF), Surface Mount Box with White Finish (SM)
F5-8-4-SD-TBAR-SM	F5000 Series (F5), 8 Watt MR16 LED (8), 4 Hour Run Time (4), Self Diagnostic System (SD), T-Grid, T-Bar Mounting Kit (TBAR), Surface Mount Box with White Finish (SM)
F5-8-4-SD-CF-TBAR-SM	F5000 Series (F5), 8 Watt MR16 LED (8), 4 Hour Run Time (4), Self Diagnostic System (SD), Custom Finish, Per-Fixture Note U.S. RAL# Required (CF), T-Grid, T-Bar Mounting Kit (TBAR), Surface Mount Box with White Finish (SM)
F5-8-4-SD-CCEA	F5000 Series (F5), 8 Watt MR16 LED (8), 4 Hour Run Time (4), Self Diagnostic System (SD), City of Chicago Code Required Plenum Rated Sealed Recessed Back Box (CCEA)
F5-8-4-SD-FMS-CCEA	F5000 Series (F5), 8 Watt MR16 LED (8), 4 Hour Run Time (4), Self Diagnostic System (SD), Flush Mounting System (FMS), City of Chicago Code Required Plenum Rated Sealed Recessed Back Box (CCEA)
F5-8-4-SD-CF-CCEA	F5000 Series (F5), 8 Watt MR16 LED (8), 4 Hour Run Time (4), Self Diagnostic System (SD), Custom Finish, Per-Fixture Note U.S. RAL# Required (CF), City of Chicago Code Required Plenum Rated Sealed Recessed Back Box (CCEA)
F5-8-4-SD-FMS-CF-CCEA	F5000 Series (F5), 8 Watt MR16 LED (8), 4 Hour Run Time (4), Self Diagnostic System (SD), Flush Mounting System (FMS), Custom Finish, Per-Fixture Note U.S. RAL# Required (CF), City of Chicago Code Required Plenum Rated Sealed Recessed Back Box (CCEA)

F5000 Series

(Battery System Included)

Part Numbers

F5-8-4-SD-TBAR-CCEA	F5000 Series (F5), 8 Watt MR16 LED (8), 4 Hour Run Time (4), Self Diagnostic System (SD), T-Grid, T-Bar Mounting Kit (TBAR), City of Chicago Code Required Plenum Rated Sealed Recessed Back Box (CCEA)
F5-8-4-SD-FMS-TBAR-CCEA	F5000 Series (F5), 8 Watt MR16 LED (8), 4 Hour Run Time (4), Self Diagnostic System (SD), Flush Mounting System (FMS), T-Grid, T-Bar Mounting Kit (TBAR), City of Chicago Code Required Plenum Rated Sealed Recessed Back Box (CCEA)
F5-8-4-SD-CF-TBAR-CCEA	F5000 Series (F5), 8 Watt MR16 LED (8), 4 Hour Run Time (4), Self Diagnostic System (SD), Custom Finish, Per-Fixture Note U.S. RAL# Required (CF), T-Grid, T-Bar Mounting Kit (TBAR), City of Chicago Code Required Plenum Rated Sealed Recessed Back Box (CCEA)
F5-8-4-SD-FMS-CF-TBAR-CCEA	F5000 Series (F5), 8 Watt MR16 LED (8), 4 Hour Run Time (4), Self Diagnostic System (SD), Flush Mounting System (FMS), Custom Finish, Per-Fixture Note U.S. RAL# Required (CF), T-Grid, T-Bar Mounting Kit (TBAR), City of Chicago Code Required Plenum Rated Sealed Recessed Back Box (CCEA)